

NEW

PAKITS FLYER

ALL PRODUCTS MEET OR EXCEED OE MANUFACTURER'S SPECIFICATIONS.
FOR MORE COMPREHENSIVE FITMENT APPLICATIONS AND SPECIFICATION DATA VISIT OUR WEBSITE

SEPT 2025



BEL8801

Non-Genuine Toro TimeMaster & TurfMaster 30" Cut Synchronous Cogged Deck Belt

Fits: 30" cut TORO TimeMaster (models 20199 years 2012 to 2017 ser 312017873 - 316999999, 20200 years 2013 to 2017 ser 313000001 - 316999999, 21199 years 2017 to 2023 ser 400000000 - 999999999, 21200 years 2018 to 2021 ser 400000000 - 999999999, 21219 year 2025 ser 400000000 - 999999999 and 21220 year 2025 ser 400000000 - 999999999), TurfMaster (models 22200 years 2013 to 2016 ser 313000001 - 315999999 and 22210 years 2017 to 2018 ser 400000000 - 403599999) and TurfMaster HDX (model 22215 years 2019 to 2024 ser 400000000 - 999999999) commercial self-propelled walk-behind lawnmower models.

Deck: 30" Cut
Length Outside Circumference: 44.094", 1120 mm
Pitch: 0.314", 8 mm
Width: 0.787", 20 mm
Teeth: 140
Standard Pack: 1
Replaces OEM: Toro: 120-3335, 120-3335-SL



\$61.30 EACH +GST



BLR8799

Non-Genuine Toro 60" Cut Copperhead Toothed Mulcher Blade

3 blades required for 60" cut.

Copperhead toothed mulcher blade, flat and fluted, right hand cut.
Fits: 60" cut TORO Z Master Commercial 3000 Series (models 72936 ser 400000000 - 999999999 year 2020 and 72950 ser 400000000 - 999999999 years 2020 to 2021), Z Master Professional 4000 Series (models 74054TA ser 400000000 - 999999999 years 2020 to 2025 and 74055TA ser 400000000 - 418031552 years 2020 to 2024), Z Master Professional 6000 Series (models 72946 ser 400000000 - 999999999 years 2020 to 2023, 72960 ser 400000000 - 999999999 years 2020 to 2025 and 72967 ser 400000000 - 999999999 years 2020 to 2024) and Z Master Professional 7000 Series (model 72267 ser 400000000 - 999999999 years 2020 to 2021) side discharge zero turn radius (ZTR) ride-on models.

Deck: 60" Cut
Centre Hole Type: Round
Centre Hole Diameter: 15/16", 23.81 mm
Length: 20 1/2", 520.7 mm
Width: 2 1/2", 63.5 mm
Thickness: .204", 5.181 mm
Standard Pack: 1

Replaces OEM: Toro: 103-6403-S, 137-9826, 140-1240, 140-1241, 140-4877, 140-4880



\$24.41 EACH +GST



GSL8768

Non-Genuine Honda GX110, GX120, GX140, GX160, GX200 Carburettor Gaskets

Fits: Honda GX110, GX120, GX140, GX160, GX200 engine models.
Standard Pack: 10
Replaces OEM: Honda: 16221-ZE0-306, 16221-ZE1-000, 16221-ZH8-800, 16221-ZH8-801



\$1.08 EACH +GST

1ST OF AUG - 30TH OF NOV

Spring INTO Summer

15% SALE

10%
20%
25%

SPEAK TO YOUR LOCAL REP ABOUT MAXIMISING YOUR SAVINGS!

ALL PRODUCTS MEET OR EXCEED OE MANUFACTURER'S SPECIFICATIONS.
 FOR MORE COMPREHENSIVE FITMENT APPLICATIONS AND SPECIFICATION DATA VISIT OUR WEBSITE

SEPT 2025

GENUINE



Hydro-Gear is the driving force inside the most trusted machines on the planet. the world's leading manufacturer of drivetrain solutions - hydrostatic drives, transaxles, and fully electric drive systems. Whether it's a heavy-duty industrial machine or a residential mower, They're the reason our customers keep moving forward.



HYD52114

Genuine Hydro-Gear Spin-On Filter
 2.6 X 3.0 ZT-2800 / ZT-3100 /
 ZT-3200 / ZT-3400 /
 ZT-3600 / ZT-3800
 Standard Pack: 1



\$34.24 EACH
 +GST



HYD71943

Genuine Hydro-Gear Oil
 Filter Kit ZT-5400
 Standard Pack: 1



\$52.15 EACH
 +GST



HYD72537

Genuine Hydro-Gear Oil
 Filter Kit ZT-4400
 Standard Pack: 1



\$52.85 EACH
 +GST

ALL PRODUCTS MEET OR EXCEED OE MANUFACTURER'S SPECIFICATIONS.
 FOR MORE COMPREHENSIVE FITMENT APPLICATIONS AND SPECIFICATION DATA VISIT OUR WEBSITE

SEPT 2025



AUTHORISED DISTRIBUTOR

Hydro-gear service and warranty distributor for Australia.
 Contact our sales team for more info.



HYD73107
 Genuine Hydro-Gear Seal Kit
 ZT-2800 / ZT-3100 / ZT-3200
 Standard Pack: 1



\$148.66 EACH +GST



HYD73239
 Genuine Hydro-Gear Seal Kit ZT-3400
 Standard Pack: 1



\$144.89 EACH +GST

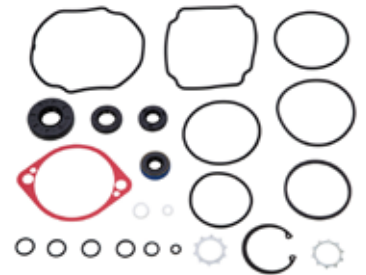

HYD70525
 Genuine Hydro-Gear Overhaul Seal Kit
 Standard Pack: 1



\$96.45 EACH +GST



HYD51563
 Genuine Hydro-Gear Spin-On Filter
 Standard Pack: 1



\$39.55 EACH +GST



HYD72750
 Genuine Hydro-Gear Oil Service Kit
 ZT-2800 / ZT-3100 / ZT-3200 / ZT-3400 / ZT-3600 / ZT-3800
 Standard Pack: 1



\$211.74 EACH +GST



HYD72881
 Genuine Hydro-Gear Oil Service Kit
 ZT-4400 & ZT-5400
 Standard Pack: 1



\$394.04 EACH +GST

ALL PRODUCTS MEET OR EXCEED OE MANUFACTURER'S SPECIFICATIONS.
 FOR MORE COMPREHENSIVE FITMENT APPLICATIONS AND SPECIFICATION DATA VISIT OUR WEBSITE

SEPT 2025



CRT45-0566

Agri-Fab, 22.68 KG (50 lb) Deluxe Push Spreader

The 50 lb. Deluxe Push Spreader will help you grow the beautiful lawn that you've always wanted. The 10-inch flat free tires provide a smooth transport on the project area. An enclosed gearbox helps protect the gears for a long lifespan. A hopper cover and grate are optional accessories. The cover is used to keep the material dry and the grate improves material flow and spreader performance. A cable flow control provides an easy method to open or close during spreading, with a large handle for easy use.

- Perfect for fertilising or weed control.
- Tool-less assembly
- 10-inch poly wheels
- Enclosed gear box with bevel gears for longer life and smoother rolling
- Build-in side deflector for integrated media directional control
- Rust-proof poly hopper and spreader plate increases product life.
- Durable cable control with large handle for easy use
- Fold-up kickstand allows to hang on wall for easy storage
- Optional Extras: Grate & Cover
- Made in the USA with global materials.

Weight: 8 lbs, 3.63 kg
Length: 29.96", 761 mm
Width: 16.94", 430 mm
Height: 33.86", 860 mm
Wheels / Tyres: 10" (254 mm) Poly wheels.
 Standard Pack: 1
 Replaces OEM: 45-0566



\$193.69 EACH
 +GST



CRT45-0532

Agri-Fab, 38.55 KG (85 lb) Push Broadcast Spreader Pro

The 85 lb. Push Spreader Pro will help you grow the beautiful lawn that you've always wanted. This spreader is designed to evenly fertilise your lawn with nutrients it needs for growth, colour, root strength and overall health.

- Perfect for fertilising or weed control.
- Easy set controls allow for precise amount of product to be distributed onto lawns.
- Rust-proof poly hopper and spreader plate increases product life.
- Corrosion resistant hardware.
- Manoeuvrable - Pneumatic tyres let you go anywhere to get the job completely done.
- Made in the USA with global materials.
- 38.55 kgs (85 lb.) capacity covers approximately 1,011 square metres (1/4 acre or 14,000 sq. ft.) depending on material used and speed of application.

Weight: 22 lbs, 9.979 kg
Length: 20.0", 508 mm
Width: 22.5", 571.5 mm
Height: 27.5", 698.5 mm
Wheels / Tyres: 10" (254 mm) Pneumatic wheels.
 Standard Pack: 1
 Replaces OEM: 45-0532



\$358.28 EACH
 +GST

ALL PRODUCTS MEET OR EXCEED OF MANUFACTURER'S SPECIFICATIONS.
 FOR MORE COMPREHENSIVE FITMENT APPLICATIONS AND SPECIFICATION DATA VISIT OUR WEBSITE

SEPT 2025

MADE IN AUSTRALIA

We at **GA Power Equipment Spares** make a range of reels in our factory, in Narangba *Australia*.

- Heavy duty cutting cylinder reel.
- Painted red.



CCA8447

Non-Genuine Rover, Scott Bonnar, 17" Cut, 8 Blade Heavy Duty Cylinder Reel, Painted Red - Made In Australia

- Suits 17" (432 mm) cut.
- 8 Blade applications.

Fits: Rover branded Model 45 and Select Model 45 cylinder reel mowers (models 45048, 45058, 45148 and 45158) as an 8 blade reel option.

Fits: Scott Bonnar branded Model 45 and Select Model 45 cylinder reel mowers (models 45048, 45058, 45148 and 45158) as an 8 blade reel option.

Width: 17", 432 mm

Standard Pack: 1

Replaces OEM: Rover / Scott Bonnar: 451581, A451581



\$431.67 EACH +GST



CCA9106

Non-Genuine Rover, Scott Bonnar, 20" Cut Heavy Duty Cylinder Reel, 8 Blade - Made In Australia

- Suits 20" (508 mm) cut
- 8 Blade applications

Fits: Rover selected cylinder reel mower models.

Fits: Scott Bonnar selected cylinder reel mower models.

Width: 20", 508 mm

Standard Pack: 1

Replaces OEM: Rover / Scott Bonnar: A451080



\$459.67 EACH +GST



CCA3011050

Non-Genuine Supaswift, 417ACM - 17" Cut, 10 Blade Cylinder Reel - Made In Australia

- Suits 17" (432 mm) cut.
- 10 Blade applications.

Fits: 17" (431.8 mm) cut SupaSwift (model 417ACM) cylinder reel mowers.

Width: 17", 432 mm

Standard Pack: 1

Replaces OEM: Supaswift: 3011050



\$532.96 EACH +GST



CCA3011090

Non-Genuine Supaswift, 420ACM - 20" Cut, 10 Blade Cylinder Reel - Made In Australia

- Suits 20" (508 mm) cut
- 10 Blade applications

Fits: 20" (508 mm) cut SupaSwift (model 420ACM) cylinder reel mowers.

Width: 20", 508 mm

Standard Pack: 1

Replaces OEM: Supaswift: 3011090



\$569.31 EACH +GST

ALL PRODUCTS MEET OR EXCEED OE MANUFACTURER'S SPECIFICATIONS.
 FOR MORE COMPREHENSIVE FITMENT APPLICATIONS AND SPECIFICATION DATA VISIT OUR WEBSITE

SEPT 2025

PROKUT Chain Features

- Designed and engineered in Australia for Australian conditions.
- Every component is precisely manufactured from high quality German steel.
- Engineered for precision, balance and low vibration.
- Manufactured to exacting standards of strength, durability and quality.
- Chromed cutters for a sharper edge and a longer life.
- Every single rivet used in PROKUT chain is individually induction-hardened for a precise, consistent hardness providing unrivalled stretch and wear resistance.
- Each PROKUT chain is pre-stretched including bulk chain rolls. This provides a high-performance chain that is ready to use with the absolute minimum of stretch straight out of the box!



GAF20F025R

Prokut 3/8" LP (Low Profile)
 Pitch x .050" Gauge x 25' Roll
 Of Full-Chisel Chainsaw Chain

Length: , 25'
Chain Number: 20F
Chain / Cutter Type: 20F / Full-Chisel
Pitch: 3/8" Low Profile
Gauge: .050"
Grind: Round
Sequence: Standard
Drive Link Count: 140
Standard Pack: 1



GAF20F100R

Prokut 3/8" LP (Low Profile)
 Pitch x .050"
 Gauge x 100' Roll Of Full-
 Chisel Chainsaw Chain

Length: , 100'
Chain Number: 20F
Chain / Cutter Type: 20F / Full-Chisel
Pitch: 3/8" Low Profile
Gauge: .050"
Grind: Round
Sequence: Standard
Drive Link Count: 1,640
Standard Pack: 1



\$82.74 EACH
 +GST



\$322.58 EACH
 +GST

GAF20F045DL

Prokut 3/8" LP (Low Profile)
 Pitch x .050" Gauge x 45
 Drive Link Loop Of Full Chisel
 Chainsaw Chain Packed
 In A Retail Blister Pack

Fits: Selected chainsaws up to 42 cc when fitted with a 12" (30 cm) long x 3/8" low profile x .050" gauge x 45 drive link guide bar.
Chain Number: 20F
Chain / Cutter Type: 20F / Full-Chisel
Pitch: 3/8" Low Profile
Gauge: .050"
Grind: Round
Sequence: Standard
Drive Link Count: 45
Standard Pack: 1



\$10.80 EACH
 +GST

GAF20F050DL

Prokut 3/8" LP (Low Profile)
 Pitch x .050" Gauge x 50
 Drive Link Loop Of Full-Chisel
 Chainsaw Chain Packed
 In A Retail Blister Pack

Fits: Selected chainsaws up to 42 cc when fitted with a 14" (35 cm) long x 3/8" low profile x .050" gauge x 50 drive link guide bar.
Chain Number: 20F
Chain / Cutter Type: 20F / Full-Chisel
Pitch: 3/8" Low Profile
Gauge: .050"
Grind: Round
Sequence: Standard
Drive Link Count: 50
Standard Pack: 1



\$12.00 EACH
 +GST

ALL PRODUCTS MEET OR EXCEED OE MANUFACTURER'S SPECIFICATIONS.
FOR MORE COMPREHENSIVE FITMENT APPLICATIONS AND SPECIFICATION DATA VISIT OUR WEBSITE

SEPT 2025

20F features

Blued components resist corrosion and provide superior strength.
Anti-kickback features for additional safety including specially designed drive links, tie straps & depth gauges.
Specially designed features to increase lubrication including oil cavities, indentations and channels.
Cutters designed to absorb and reduce vibration to limit equipment wear and operator fatigue.



| P/N | PITCH | GAUGE | CUTTER SEQUENCE | KICKBACK SAFETY | CUTTER TYPE | BAR LENGTH | SAW SIZES |
|-----|------------------|-------|---|---------------------|-------------|-------------------|-------------|
| 20F | 3/8" Low Profile | .050" |  | Ramped Depth Gauges | Full-Chisel | Up to 18" (45 cm) | Up to 42 cc |

GAF20F052DL

Prokut 3/8" LP (Low Profile)
Pitch x .050" Gauge x 52
Drive Link Loop Of Full-Chisel
Chainsaw Chain Packed
In A Retail Blister Pack

Fits: Selected chainsaws up to 42 cc when fitted with a 14" (35 cm) long x 3/8" low profile x .050" gauge x 52 drive link guide bar.

Chain Number: 20F

Chain / Cutter Type: 20F / Full-Chisel

Pitch: 3/8" Low Profile

Gauge: .050"

Grind: Round

Sequence: Standard

Drive Link Count: 52

Standard Pack: 1



GAF20F055DL

Prokut 3/8" LP (Low Profile)
Pitch x .050" Gauge x 55
Drive Link Loop Of Full-Chisel
Chainsaw Chain Packed
In A Retail Blister Pack

Fits: Selected chainsaws up to 42 cc when fitted with a 16" (40 cm) long x 3/8" low profile x .050" gauge x 55 drive link guide bar.

Chain Number: 20F

Chain / Cutter Type: 20F / Full-Chisel

Pitch: 3/8" Low Profile

Gauge: .050"

Grind: Round

Sequence: Standard

Drive Link Count: 55

Standard Pack: 1



\$12.48 EACH +GST



\$13.20 EACH +GST

GAF20F056DL

Prokut 3/8" LP (Low Profile)
Pitch x .050" Gauge x 56
Drive Link Loop Of Full-Chisel
Chainsaw Chain Packed
In A Retail Blister Pack

Fits: Selected chainsaws up to 42 cc when fitted with a 16" (40 cm) long x 3/8" low profile x .050" gauge x 56 drive link guide bar

Chain Number: 20F

Chain / Cutter Type: 20F / Full-Chisel

Pitch: 3/8" Low Profile

Gauge: .050"

Grind: Round

Sequence: Standard

Drive Link Count: 56

Standard Pack: 1



\$13.44 EACH +GST



ALL PRODUCTS MEET OR EXCEED OE MANUFACTURER'S SPECIFICATIONS.
FOR MORE COMPREHENSIVE FITMENT APPLICATIONS AND SPECIFICATION DATA VISIT OUR WEBSITE

SEPT 2025

AIR7998

Non-Genuine Toro,
Loncin, Cartridge Air
Filter and Pre-Filter

Fits: Toro (Loncin) LC2P77F, 24.5 hp 708cc OHV V-Twin engines as fitted to selected Toro equipment including but not limited to - **Fits:**

42" (1067 mm) cut TORO TimeCutter MX 4200 [MX4200] (model 74766 years 2017 to 2021 with ser # 402582146 - 999999999), MX 4250 [MX4250] (models 74760, years 2015 to 2020 with ser # 315000001 - 999999999 and 74760TA years 2019 to 2021 with ser # 400000000 - 999999999), MX 4275 [MX4275] (model 75745TA years 2020 to 2022 with ser # 400000000 - 410999999), SS4225 [SS 4225] (models 74726 years 2018 to 2020 with ser # 400000000 - 999999999 and 74726TA years 2019 to 2021 with ser # 400000000 - 999999999), 75742TA years 2020 to 2022 with ser # 400000000 - 999999999 and SS 4250 (model 74723, years 2015 to 2016 with ser # 315000001 - 316999999) zero turn radius (ZTR) ride-on lawn mower models and SW 4200 [SW4200] (model 74784 years 2015 to 2016 with ser # 315000001 - 316999999) zero turn radius (ZTR) with steering wheel) ride-on lawnmower models. **Fits:** 48"(1220 mm) cut TORO TimeCutter HD series HD MyRide MR 4800 [MR4800] (model 72511 years 2018 to 2019 with ser # 400000000 - 999999999), HD ZX4800 [HD ZX 4800, ZX4800, ZX 4800] (model 75201 years 2017 to 2020 with ser # 400000000 - 999999999) and TITAN HD 1500 (model 74450 years 2017 to 2018 with ser # 400000000 - 999999999) zero turn radius (ZTR) ride-on lawn mower models. **Fits:** 50" (1270 mm) cut TORO TimeCutter MX 5000 [MX5000] (model 74775 years 2017 to 2019 with ser # 316000001 - 999999999), MX 5050 [MX5050] (models 74771 year 2018 with ser # 400000000 - 999999999 and 74774 years 2019 to 2021 with ser # 404310000 - 999999999), MX 5075 [MX5075] (models 74778 years 2018 to 2022 with ser # 400000000 - 999999999 and 75755TA years 2020 to 2023 with ser # 400000000 - 999999999), SS 5000 [SS5000] (model 74731, years 2015 to 2016 with ser # 315000001 - 999999999) zero turn radius (ZTR) ride-on lawn mower models and SWX 5050 (model 74797 year 2015 with ser # 315000001 - 315999999) zero turn radius (ZTR with steering wheel) ride-on lawnmower models. **Fits:** 54" (1370 mm) cut TORO TimeCutter MR5400 [HD MR 5400] (model 75212 years 2017 to 2020 with ser # 400000000 - 999999999) zero turn radius (ZTR) ride-on lawn mower models. **Fits:** 60" (1524 mm) cut TORO TimeCutter MX 6050 [MX6050] (model 74777 year 2018 ser # 400000000 - 999999999) zero turn radius (ZTR) ride-on lawn mower models.

Length: 6.14", 156 mm

Width: 3.03", 77 mm

Height: 3.14", 80 mm

Standard Pack: 1

Replaces OEM: Toro: 127-9252, 136-7806 [Air Filter & Pre-Filter], 127-9288, 136-7804 [Foam Wrap Pre-filter].



\$16.96 EACH +GST

LON150350046-0002

Husqvarna, Loncin, Stiga,
Supaswift, Toro, Oil Filter

Fits: Husqvarna selected models when fitted with Husqvarna (Loncin) HS452, HV 586AE and HS 413 AE engine models including but not limited to R 214, [R214TC, R 214TC] (model 970542301 year 2022) out front deck rider models and TC138 [TC 138] (model 96041042900 years 2019 to 2021) and TS142 [TS 142] (96041043000 years 2019 to 2021) ride-on lawn mower models.

Fits: Loncin selected engine models including but not limited to LC1P91F (546 cc, 11 kW), LC1P92F-1 (452 cc, 9.2 kW) and LC1P96F (608 cc, 11.5 kW) LC Power vertical shaft single cylinder ride-on lawnmower engine series.

Fits: Stiga selected ride-on lawn mower models fitted with TRE586VA engine models.

Fits: SupaSwift SSV450F1 (code number T381000008-3779008, our engine part number ENG8380) 452 cc vertical shaft single cylinder ride-on lawnmower engine series.

Fits: Toro selected models when fitted with Toro (Loncin) engine part numbers 121-0412, 127-9358, 133-9971, 133-9973, 136-7813, 136-7818, 139-0601, 139-0603, 139-0605 including but not limited to 32" (813 mm) cut TORO TimeCutter SS 3200 [SS3200] (model 74621 year 2014), SS 3225 [SS3225] (models 74710 years 2015 to 2019 and 74710TA year 2019), 34" (863 mm) cut TORO TimeCutter MX 3450 [MX3450] (model 74750 years 2015 to 2016), 42" (1067 mm) cut TORO TimeCutter MX 4200 [MX4200] (model 74766 years 2017 to 2018), MX 4250 [MX4250] (models 74760 year 2016 to 2022 and 74760TA year 2021), MX 4275 [MX4275] (model 75745TA years 2020 to 2022), SS 4200 [SS4200] (model 74720 years 2015 to 2017), SS 4216 [SS4216] (model 74616 year 2014), SS 4225 [SS4225] (models 74726 year 2018 to 2020, 74726TA year 2021 and 75742TA years 2020 to 2022), SS 4250 [SS4250] (model 74723 year 2016), SW 4200 [SW4200] (model 74784 year 2016), 48" (1220 mm) cut TORO TimeCutter HD Series HD ZX4800 [HD ZX 4800, ZX4800, ZX 4800] (model 75201 years 2017 to 2020), MR 4800 [MR4800] (model 75211 years 2018 to 2019), 50" (1270 mm) cut TORO TimeCutter MX 5075 [MX5075] (models 74778 years 2018 to 2019 and 75755TA years 2020 to 2022), SWX 5050 [SWX5050] (model 74797 years 2015 to 2017), 54" (1370 mm) cut TORO TimeCutter HD Series [MR5400 [HD MR 5400] (model 75212 years 2019 to 2020), 60" (1524 mm) cut TORO TimeCutter MX 6050 [MX6050] (model 74777 year 2018) zero turn radius (ZTR) ride-on models.

Standard Pack: 1

Replaces OEM: Husqvarna: 591 16 59-01, 591 04 33-01 / Stiga: 118551566/0 / SupaSwift / Loncin: 150350019-T240, 150350041-0001, 150350046-0002 / Toro: 120-4276, 127-9222, 136-7848



\$9.02 EACH +GST

LON270360054-0001

Non-Genuine Toro, Loncin, Starter Motor

Fits: Toro TimeCutter MX 4200 [MX4200] (model 74766 years 2017 to 2019), TimeCutter MX 4250 [MX4250] (models 74760 years 2015 to 2019 and 74760TA year 2021), TimeCutter MX 4275 [MX4275] (model 75745TA years 2020 to 2021), TimeCutter MX 5000 [MX5000] (model 74775 years 2016 to 2018), TimeCutter MX 5050 [MX5050] (models 74771 years 2016 to 2018 and 74774 years 2019 to 2020), TimeCutter MX 5075 [MX5075] (models 74778 year 2018 to 2020 and 75755TA years 2020 to 2021), TimeCutter MX 6050 [MX6050] (model 74777 year 2018), TimeCutter SS 4225 [SS4225] (models 74726 years 2018 to 2019, 74726TA year 2021 and 75742TA years 2020 to 2021), TimeCutter SS 4250 [SS4250] (model 74723 years 2015 to 2016), TimeCutter SS 5000 [SS5000] (model 74731 years 2015 to 2016), TimeCutter SW 4200 [SW4200] (model 74784 years 2015 to 2016), TimeCutter SWX 5050 [SWX5050] (model 74797 years 2015 to 2017), TimeCutter HD Series MR 4800 [MR4800] (model 75211 years 2018 to 2019), MR5400 [HD MR 5400] (model 75212 years 2017 to 2019), TimeCutter HD Series ZX4800 [HD ZX 4800, ZX4800, ZX 4800] (model 75201 years 2017 to 2019), TITAN (models 75302 year 2021, 75311TA year 2020 and 75312TA year 2020), TITAN HD 1500 Series (model 74450 years 2017 to 2018), TITAN HD 2000 Series (models 74465 year 2019, 74466 year 2019 and 74467 year 2019), TITAN ZX 4800 [ZX4800] (model 75301TA years 2020 to 2021) and Z Master Professional 2000 Series (models 74490 year 2020, 74493 year 2020, 74494 year 2020, 77280 year 2020 and 77293 year 2020) zero turn radius (ZTR) ride-on models when fitted with TORO 2P77F, 22.5 hp (16.8kW) and 24.5 hp (18.3 kW) 708 cc, (Loncin) V-Twin cylinder OHV, vertical shaft engine models.

Standard Pack: 1

Replaces OEM: Loncin: 270360054-0001, 270360146-0001, 270360170-0001

Toro: 127-9209, 133-1564, 133-9828, 136-7880



\$133.24 EACH +GST

GASPARES.COM.AU

All original equipment, manufacturer's names and part numbers and photographs or drawings of their products are used for identification purposes only, and, unless otherwise expressly stated, our products are not original equipment manufacturer's parts. All products advertised were in reasonable quantities at the date of printing. Roy Gripske & Sons Pty. Ltd. will do everything possible to maintain stock of product advertised, but cannot be responsible for product out of stock at time of ordering, or through any other circumstances beyond the control of Roy Gripske & Sons Pty. Ltd. E & O.E. Roy Gripske & Sons Pty. Ltd. shall not be liable for technical or editorial errors or omissions contained herein, nor for incidental or consequential damages resulting from furnishing this material. The information is provided "as is" without warranty of any kind and is subject to change without notice. Roy Gripske & Sons Pty. Ltd. also reserves the right to revise the content at any time without prior notice.
Copyright © 2025 Roy Gripske & Sons Pty. Ltd. All Rights Reserved.
Prices do not include 10% GST unless stated. Prices valid until 30th September 2025.

Proudly supporting



Royal Flying Doctor Service
QUEENSLAND SECTION



PLEASE RECYCLE



PROUDLY AUSTRALIAN OWNED & OPERATED

PHONE QLD 1300 363 004 | NSW 1300 363 005 | VIC 1300 760 480 | WA 1300 307 574 | SA 1300 781 352 | TAS 1300 760 480

FAX QLD 1800 636 973 | NSW 1800 640 366 | VIC 1800 220 582 | WA 1800 023 888 | SA 1800 453 352 | TAS 1800 220 582